



Dual-Sensor Human Temperature Screening IP Camera

Features

- Optical and thermal dual-sensor design for easy tracking of people and their temperature
- Great measurement range with 384x288 thermal sensor
- Face detection to avoid false alerts due to mismeasurement on irrelevant objects
- Instant alerts on people with suspected fever or without wearing face mask
- Comprehensive reports with face captures, time and measured temperature of people



Dimensions

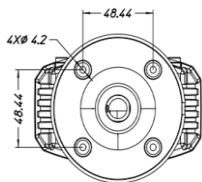
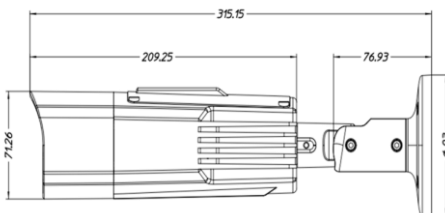

Specifications

| Model | MS2-B81M |
|------------------------------|---|
| THERMAL CAMERA | |
| Type | Uncooled VOx sensor |
| Effective Pixels | 384 x 288 |
| Pixel Size | 17µm |
| Spectral Range | 8 - 14µm |
| NETD | < 60mk (@25°C, F#=1.0, 300K, 50Hz) |
| Lens | 9.1mm |
| Angle of View | Horizontal: 39°; Vertical: 30° |
| VISIBLE CAMERA | |
| Image Sensor | Sony 1/2.8" Starlight CMOS sensor |
| Effective Pixel | 1920 (H) x 1080 (V) |
| Frame Rate | 25/30fps |
| Resolution | Up to 1920 x 1080@25/30fps (main stream); Up to D1@25/30fps (sub stream); |
| Video Compression | H.265 / H.264 (16kbps – 8000kbps) |
| Audio Compression | G.711u (64Kbps) |
| Min. Illumination | 0.0 lux (IR on), 0.01 lux@F1.4 (IR off) |
| IR Range | 5m |
| Lens | 6mm |
| Electronic Shutter | Auto / manual (1/5~1/100000) |
| S/N Ratio | ≥50db (AGC off) |
| Video Adjustment | Brightness, contrast, saturation, sharpness, hue |
| 3D Noise Reduction | Close / low / mid / mid-high / high |
| True WDR | Close / low / mid / high |
| Day / Night | Auto / color / B/W / external |
| Privacy Mask | 4 zones |
| TEMPERATURE DETECTION | |
| Measurement Range | 30°C ~ 45°C |
| Measurement Accuracy | ±0.3°C (with blackbody); ±0.5°C (no black body) |
| Detection Distance | 2 – 5m (Suggest distance: 3m) |
| Simultaneous Detection | 30 persons |
| High Temperature Alarm | Support |
| Absent Face Mask Alarm | Support |
| Data Upload | Support |
| EVENT | |
| Event Type | External alarm, video motion detection, video tamper, network interruption |
| Video Analysis | Facial mask detection |
| Action Type | Dial-back, snapshot, relay switch control, FTP upload, email notification, micro SD card recording, flashing white light, audible message |
| Alarm Input | 2 |
| Motion Detection | 4 |
| Relay Output | 1 |
| COMMUNICATION | |
| Network | RJ-45, 100 base-T |
| Protocol | TCP/IP, HTTP, UDP, DHCP, RTSP, NTP, SMTP, DDNS, PPPoE, FTP, ONVIF |
| Open Standard | ONVIF (Profile S) |
| Concurrent Connection | 2 |
| Audio Input | 1 |
| Loudspeaker | 1 |
| RS485 | 1 |
| Micro SD Card Slot | 1 |
| MISCELLANEOUS | |
| Operating Environment | -10 ~ 50°C (Thermometry temperature: 10-32°C)/ 90% relative humidity (no condensation) |
| Power Supply | DC12V / PoE, 10W |
| Dimensions (mm) | 316 (W) x 49 (H) x 72 (D), excluding bracket |
| Weight | 1.7kg |

